

THIS DRAWING IS THE EXCLUSIVE PROPERTY OF MARQUARDT. WITHOUT THEIR CONSENT IT MAY NOT BE REPRODUCED OR GIVEN TO THIRD PARTIES.

CONFIDENTIAL

VERTRAULICH

Alle Rechte bei Marquardt, auch fuer den Fall von Schutzrechtsanmeldungen. Jede Veruegungsbefugnis, wie Kopier- und Weitergaberecht, bei uns.

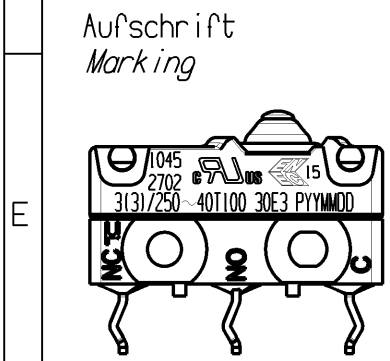
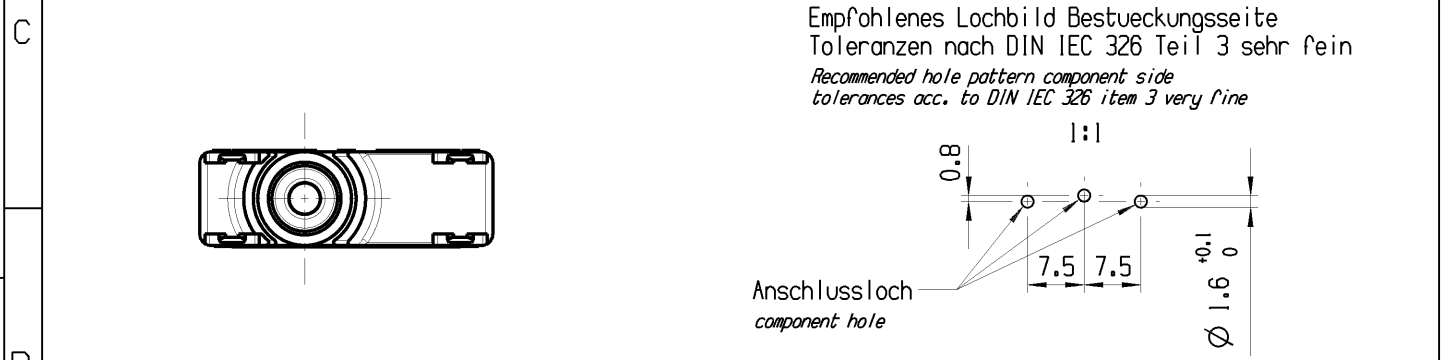
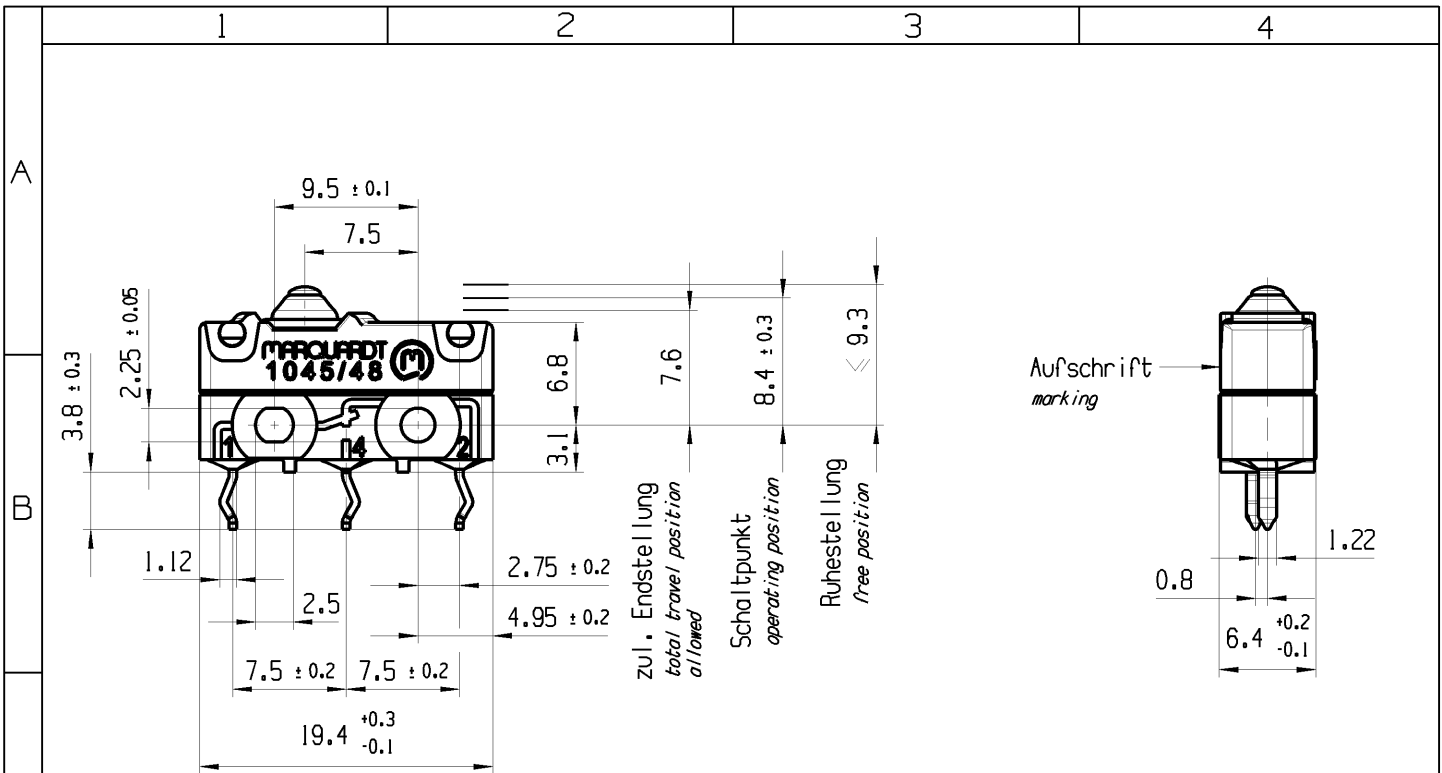

| | | | |
|----|----|----------------------------------|----------|
| NC | NO | Wechsler 1-polig | |
| 2 | 4 | single pole changeover | |
| | | Schaltbetaetigungskraft | ≤ 2.6 N |
| | | actuating force | |
| | | Rueckschaltkraft | ≥ 0.7 N |
| | | release force | |
| | | Differenzweg | ≤ 0.2 mm |
| | | movement differential | |
| | | IP Schutzklasse nach EN 60529 | IP 67 |
| | | protection class acc to EN 60529 | IP 67 |

G: Konform nach IEC 60335-1:2001 Kap. 30
G: matching IEC 60335-1:2001 clause 30

| | | | | | | | | | | |
|---------------------------------------|------------------------|---------------|---|--------------------|--|--------------------|----------------------------|--------------------|------------------------------|---------|
| fuer Form und Lage FOR SHAPE AND LOC. | ⊙ = | 0.1 | Allgemeintoleranzen UNTOLERANCED DIMENSIONS | | | Pause COPY | Blatt SHEET 01 | TYP K | Zeichn./DRAWING NO. 10452702 | Index c |
| | fuer Winkel FOR ANGLE. | ± 2 | +0.25 -0.1 | PROJEKTION | Abmasse und Nennmassbereiche Angaben in mm | | | | | |
| | | | ALL DIMENSIONS ARE IN MILLIMETRES | 0-6 ± 0.1 ± 0.2 | >6-15 ± 0.15 ± 0.3 | >15-30 ± 0.2 ± 0.5 | | | SCHNAPPSCHALTER | |
| | | | | >30-70 ± 0.3 ± 10% | >70-120 ± 0.4 ± 0.8 | | | Snap action switch | | |
| c | 83090 | 11.03.13 | BRC | | | | CAD: NX v6.0 | | | |
| b | 78489 | 26.04.12 | BRC | | | | gez./DRAWN BY 30.05.11 BRC | | | |
| a | 77237 | 06.02.12 | BRC | | | | gepr./CHECKED BY | | | |
| | 73556 | 06.07.11 | LM | | | | Ersatz fuer/REPLACEMENT OF | | | |
| Ausg. ISSUE | Aenderung REVISION | gez. DRAWN BY | Ausg. ISSUE | Aenderung REVISION | gez. DRAWN BY | MARQUARDT | | | | |